

ELEVATION 9-9

1 : 200

MATERIALS KEY

- Polyester powder-coated (PPC) cladding components**
- 1. PPC aluminium standing seam effect cladding.
- 2. Profiled PPC aluminium cladding inset panel.
- 3. Profiled PPC aluminium spandrel panel.
- Brick cladding components**
- 10. Facing stretcher bond brickwork cladding.
- Door & window components**
- 20. Metal frame glazed window.
- 21. Metal frame glazed door.
- 22. Draft lobby with glazed sliding door.
- 23. Metal louvre facing doors (WPD).
- Misc components**
- 30. Metal fin balcony balustrade with removable planter.
- 31. Metal fin Juliet balustrade with removable planter.
- 32. Metal fin balustrade.



IMPORTANT NOTES:
Do not scale from drawings. All dimensions shall be checked on site before commencement of work. All discrepancies shall be brought to the attention of the Architect. Larger scale drawings and written dimensions take precedence. This drawing is copyright and the property of the author, and must not be retained, copied or used without the express authority of MARCHESE PARTNERS INTERNATIONAL PTY. LTD.

REVISION	DATE	DESCRIPTION	BY
-	20/12/19	PLANNING APPLICATION SUBMISSION	DR
A	27/05/21	WHEATCROFT CHANGES	DR

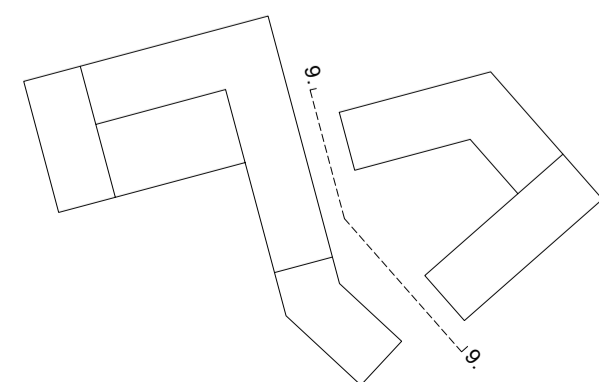

marchesepartners

Marchese Partners International Pty Ltd
Metal Box Factory, Unit GG. 212. 30 Great Guildford Street. London SE1 0HS
P +44 020 735 9755 E info@marchesepartners.com
www.marchesepartners.com
London · Sydney · Brisbane · Canberra · Melbourne · Adelaide · Perth
· Kuala Lumpur · Auckland

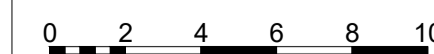

CLIENT



DRAWING TITLE

ELEVATION 9-9

PROJECT

GUILD LIVING AT EPSOM

SCALE

1:200@A1
1:400@A3

DATE

20.12.19

DRAWN

AM

CHECKED

DR

JOB

18120

DRAWING

18120-MPI-XX-ZZ-DR-A-20_309

REVISION

A

PLANNING
NOT FOR CONSTRUCTION

— SITE BOUNDARY
- - - EXISTING TERRAIN