



**ELEVATION 8-8**

1 : 200

**MATERIALS KEY**

- Polyester powder-coated (PPC) cladding components**
- 1. PPC aluminium standing seam effect cladding.
- 2. Profiled PPC aluminium cladding inset panel.
- 3. Profiled PPC aluminium spandrel panel.
- Brick cladding components**
- 10. Facing stretcher bond brickwork cladding.
- Door & window components**
- 20. Metal frame glazed window.
- 21. Metal frame glazed door.
- 22. Draft lobby with glazed sliding door.
- 23. Metal louvre facing doors (WPD).
- Misc components**
- 30. Metal fin balcony balustrade with removable planter.
- 31. Metal fin Juliet balustrade with removable planter.
- 32. Metal fin balustrade.



**IMPORTANT NOTES:**  
Do not scale from drawings. All dimensions shall be checked on site before commencement of work. All discrepancies shall be brought to the attention of the Architect. Larger scale drawings and written dimensions take precedence. This drawing is copyright and the property of the author, and must not be retained, copied or used without the express authority of MARCHESE PARTNERS INTERNATIONAL PTY. LTD.

REVISION	DATE	DESCRIPTION	BY
-	20/12/19	PLANNING APPLICATION SUBMISSION	DR
A	27/05/21	WHEATCROFT CHANGES	DR

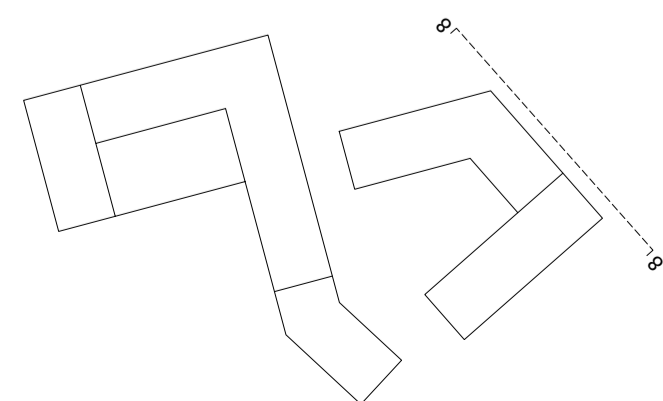

**marchesepartners**

Marchese Partners International Pty Ltd  
Metal Box Factory, Unit GG. 212. 30 Great Guildford Street, London SE1 0HS  
P +44 020 735 9755 E info@marchesepartners.com  
www.marchesepartners.com  
London · Sydney · Brisbane · Canberra · Melbourne · Adelaide · Perth  
· Kuala Lumpur · Auckland

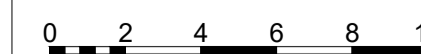

CLIENT



DRAWING TITLE

**ELEVATIONS 8-8**

PROJECT

**GUILD LIVING AT EPSOM**

SCALE  
1:200@A1  
1:400@A3

JOB  
18120

DATE  
20.12.19

DRAWING  
18120-MPI-XX-ZZ-DR-A-20\_308

DRAWN  
AM

CHECKED  
DR

REVISION  
A

**PLANNING**  
NOT FOR CONSTRUCTION

— SITE BOUNDARY  
- - - EXISTING TERRAIN