



ELEVATION 1A-1A

1 : 200

MATERIALS KEY

- Polyester powder-coated (PPC) cladding components**
 - PPC aluminium standing seam effect cladding.
 - Profiled PPC aluminium cladding inset panel.
 - Profiled PPC aluminium spandrel panel.
- Brick cladding components**
 - Facing stretcher bond brickwork cladding.
- Door & window components**
 - Metal frame glazed window.
 - Metal frame glazed door.
 - Draft lobby with glazed sliding door.
 - Metal louvre facing doors (WPD).
- Misc components**
 - Metal fin balcony balustrade with removable planter.
 - Metal fin Juliet balustrade with removable planter.
 - Metal fin balustrade.



REVISION	DATE	DESCRIPTION	BY
-	30/01/2020	STAGE 2 SUBMISSION	DR
A	24/04/20	FACADE UPDATE IN RESPONSE TO EEBC PLANNING COMMENTS	DR

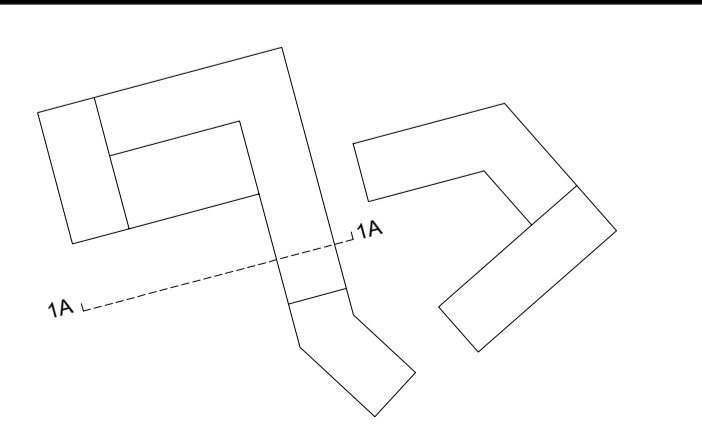

marchesepartners

Marchese Partners International Pty Ltd
 Metal Box Factory, Unit GG. 212. 30 Great Guildford Street. London SE1 0HS
 P +44 020 735 9755 E info@marchesepartners.com
 www.marchesepartners.com
 London · Sydney · Brisbane · Canberra · Melbourne · Adelaide · Perth
 · Kuala Lumpur · Auckland · Madrid



CLIENT
 GUILD LIVING

PROJECT
 GUILD LIVING AT EPSOM

CLIENT
 Legal & General

DRAWING TITLE
 ELEVATION 1A-1A

SCALE 1:200@A1 1:400@A3	DATE 24.04.2020	DRAWN AM	CHECKED DR
JOB 18120	DRAWING 18120-MPI-XX-ZZ-DR-A-20_300	REVISION A	

PLANNING
NOT FOR CONSTRUCTION

--- EXISTING TERRAIN